

## Installation Instructions: SPT T2-PV-3+0(-R)



Please read the following before installing your SPT T2 PV Surge Protective Device:

- Verify the system voltage and configuration on the label if it is appropriate for the application.
- Risk of Electric Shock – Installation and maintenance should be performed by qualified personnel only.
- Disconnect from energized circuits before installing or servicing.
- Safety rules and regulations applicable to all devices connected to power lines should always be followed. National standards and safety regulations must be respected.
- The external mechanical integrity of the device must be checked before installation. Products with visible damage should not be installed.
- Its use is only permitted within the limits shown and stated in these installation instructions. Opening or tampering with the device invalidates the warranty.
- Connecting leads shall be kept as short as possible and not exceed 0.5m in total length per SPD (in the case of a T-connection).

Product name	SPT T2-1100PV-3+0	SPT T2-1500PV-3+0
	SPT T2-1100PV-3+0-R	SPT T2-1500PV-3+0-R
U <sub>CPV</sub> (+)-PE, (-)-PE, (+)-(-)	1100 V	1500 V
V <sub>PVDC</sub> (+)-PE, (-)-PE, (+)-(-)	1100 V	1500 V
I <sub>n</sub> (8/20)	20 kA	20 kA
I <sub>total</sub> (8/20)	50 kA	40 kA
I <sub>max</sub> (8/20)	40 kA	30 kA
U <sub>p</sub> (+)-PE, (-)-PE, (+)-(-)	3800 V	5000 V
V <sub>PR</sub> (+)-PE, (-)-PE, (+)-(-)	2500 V	4000 V
I <sub>scpv</sub>	11 kA	11 kA
SCCR (UL 1449)	50 kA	65 kA
I <sub>PE</sub> (AC/DC)	0.3mA / <10µA	0.3mA / <50µA
SPD overload behaviour mode	Open Circuit Mode (OCM)	Open Circuit Mode (OCM)
Type of PV systems	Not earthed/earthed	Not earthed/earthed
Ta	-40°F to +158°F / 185°F per UL 1449 [-40°C to +70°C / 85°C per UL 1449]	
RH	5%...95%	
Mounting	35mm DIN rail, EN 60715	
Number of ports	1	
Location	Indoor	
Altitude (max)	4000m	4000m*
IP	20 (built-in)	
 (solid, stranded) stripping length 12.5mm	ø min 1.5mm <sup>2</sup> / ø max 35mm <sup>2</sup> / ø min 16 AWG / ø max 2 AWG	
 (flexible) stripping length 12.5mm	ø min 1.5mm <sup>2</sup> / ø max 25mm <sup>2</sup> / ø min 16 AWG / ø max 4 AWG	
 PH	PH2 / SLOT ¼	
 RC push in (stranded  )	ø min 0.25mm <sup>2</sup> / ø max 1.5mm <sup>2</sup> / ø min 24 AWG / ø max 16 AWG	

\*NOTE:

The minimum distance of the ProTec T2-1500PV-3+0(-R) from any earthed conductive surface at which the SPD can be installed is 2mm.

### Protection Configurations

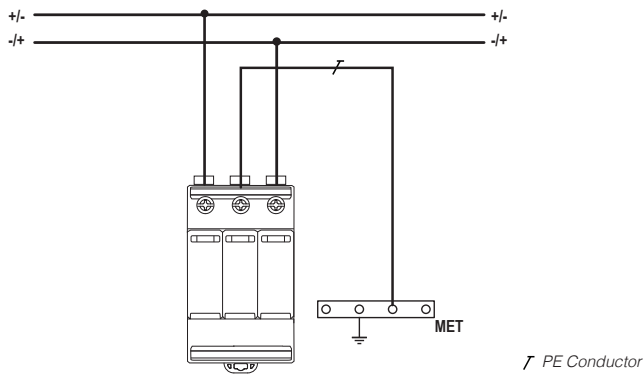

### Fault indication

\*Symbolic drawing

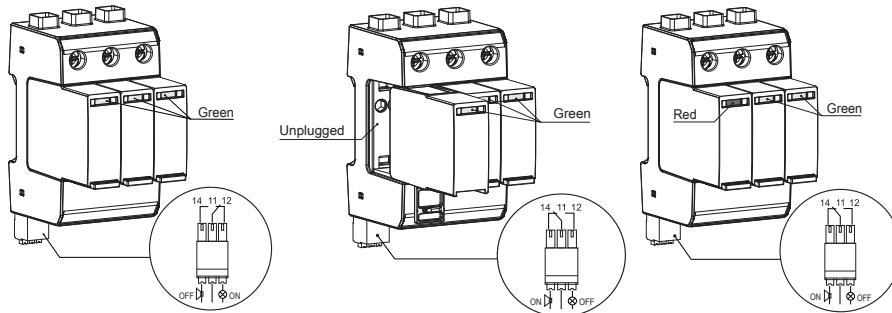

### Remote signalization

A.C.		D.C.		
250V / 1A	125V / 1A	48V / 0.5A	24V / 0.5A	12V / 0.5A

RC contact(s) states	11- 12	11-14
SPD modules(s) functional/installation is protected	Closed	Open
SPD module(s) unplugged or non-functional/ installation is unprotected	Open	Closed

### Dimensions

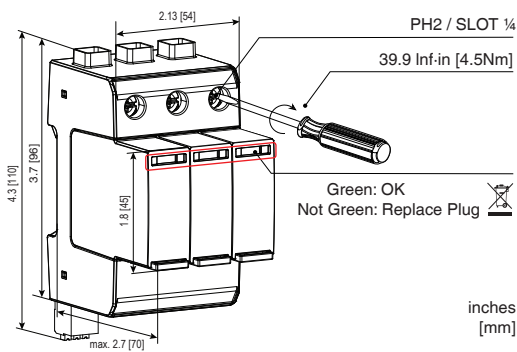

### Plug replacement

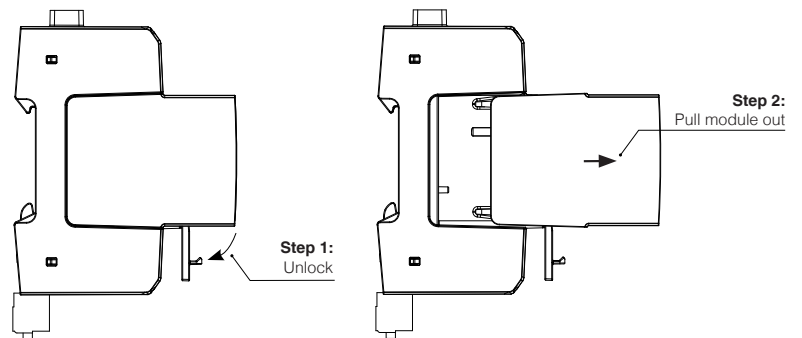

- Earthing conductors of Type 2 SPDs shall have a minimum cross-sectional area of 6mm<sup>2</sup> copper or equivalent or equal to the cross section area of live conductors, if greater than 6mm<sup>2</sup>.
- In case of existing national regulations about maintenance and control of LPS (Lightning Protection System) which are more demanding, the usage of those regulations is necessary, otherwise it is advised to do maintenance and control according to standard IEC 62305-3:2010, chapter - E.7.
- Based on the mentioned standard, annual complete control is recommended (visual control and measurements) or after every lightning strike in that area.